



# Holland Aviation b.v.

Airport and heliport, lighting and equipment, windsock assemblies

## DATASHEET

## HA-ILD LS 180

### OMNIDIRECTIONAL INSET LIGHT LED TECHNOLOGY

For direct installation onto the helideck

ENCLOSURE	Aluminium body, chromate conversion and powder coating. Sealed for life
DIMENSIONS	Ø180 x 78 mm (only 25mm above deck)
WEIGHT	1,5 Kg
LENS	Borosilicate glass, roll over type
CABLE	Standard: 1x M20 cable gland with 1,5m cable
LIGHT SOURCE	High power LED Green (White, Blue, Yellow or Red also available on request)
POWER CONSUMPTION	5 watt
EXPECTED LIFETIME	>75.000 hours
POWER SUPPLY	90-255VAC or 9-36 V AC/DC (optional)
LIGHT OUTPUT	>32 cd
AMBIENT TEMPERATURE	-40 °C to + 60 °C
INGRESS PROTECTION	IP 67
COMPLIANCES	ICAO Annex 14 Vol. II UK CAP 437 IMO 2009 MODU CODE EASA ADR
HS CODE (CUSTOMS TARIFF)	94054031

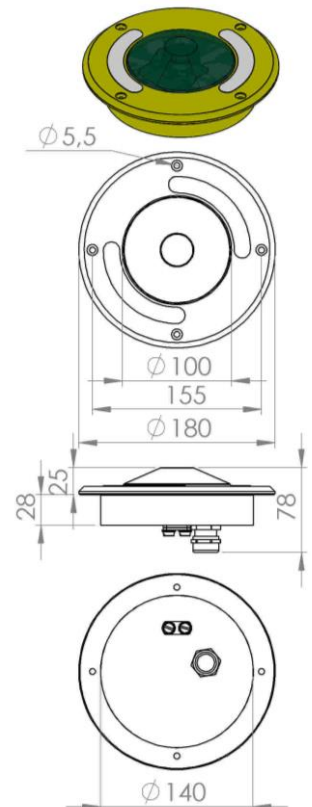

Holland Aviation  
Daniëlsweg 40  
4451 HW Heinkenszand  
The Netherlands

Tel. +31 (0)113 613467  
Fax. +31 (0)113 613570  
Email: [info@hollandaviation.com](mailto:info@hollandaviation.com)  
[www.hollandaviation.com](http://www.hollandaviation.com)



© Holland Aviation. The information contained in this document is subject to modifications without prior notice.